

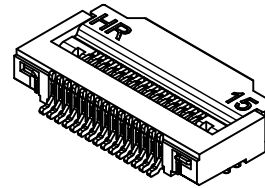

P/N LEGEND

F0515 WR-S-XP N L N XX X 00 L
 ① ② ③ ④ ⑤ ⑥ ⑦ ⑧ ⑨ ⑩ ⑪

- ① Series No.
- ② Connector type: WR=Right angle
- ③ Mounting type: S=SMT
- ④ No. of circuits
- ⑤ N=Halogen Free
- ⑥ Material: L=LCP
- ⑦ Color: N=Natural(Beige)
- ⑧ Plating code for contacts:
T1=Matte Tin-plated; G1=Gold-flash
- ⑨ Plating code for solder tabs:
T=Matte Tin-plated; G=Gold-flash
- ⑩ Option code: 00=Standard
- ⑪ Packing code: L=Tape & Reel(With Mylar)



SPECIFICATIONS

Current Rating: 0.5A AC,DC
 Voltage Rating: 50V AC,DC
 Temperature Range: -25°C ~ +85°C
 Contact Resistance: 30mΩ Max.
 Insulation Resistance: 100MΩ Min.
 Withstanding Voltage: 250V AC/minute
 Contacts: Phosphor Bronze/Matte Tin-plated or Gold-flash

Solder Tabs: Brass/Matte Tin-plated or Gold-flash
 Housing: LCP,UL94V-0,Natural(Beige)
 Cover: LCP,UL94V-0,Natural(Black)

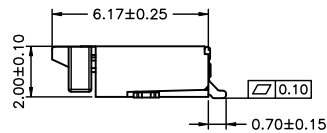
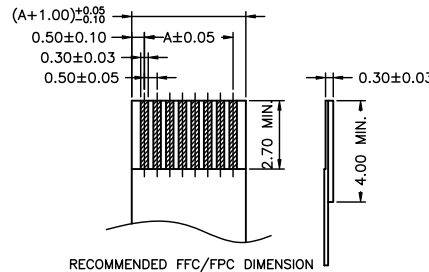
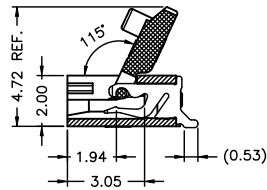
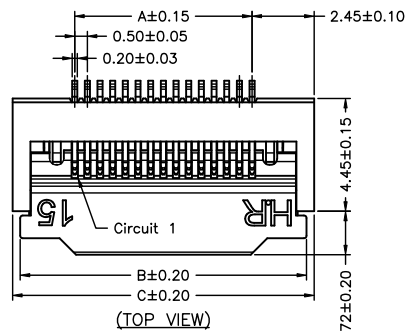
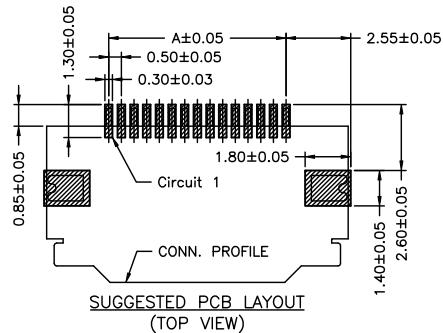

KAPTON TAPE (FOR PICK AND PLACE SYSTEMS)

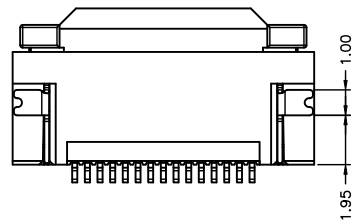
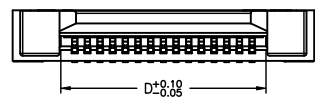
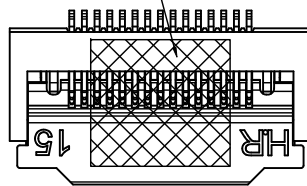

Circuit No.	Dimensions				Circuit No.	Dimensions			
	A	B	C	D		A	B	C	D
04P	1.50	5.80	6.40	2.60	26P	12.50	16.80	17.40	13.60
05P	2.00	6.30	6.90	3.10	27P	13.00	17.30	17.90	14.10
06P	2.50	6.80	7.40	3.60	28P	13.50	17.80	18.40	14.60
07P	3.00	7.30	7.90	4.10	29P	14.00	18.30	18.90	15.10
08P	3.50	7.80	8.40	4.60	30P	14.50	18.80	19.40	15.60
09P	4.00	8.30	8.90	5.10	31P	15.00	19.30	19.90	16.10
10P	4.50	8.80	9.40	5.60	32P	15.50	19.80	20.40	16.60
11P	5.00	9.30	9.90	6.10	33P	16.00	20.30	20.90	17.10
12P	5.50	9.80	10.40	6.60	34P	16.50	20.80	21.40	17.60
13P	6.00	10.30	10.90	7.10	35P	17.00	21.30	21.90	18.10
14P	6.50	10.80	11.40	7.60	36P	17.50	21.80	22.40	18.60
15P	7.00	11.30	11.90	8.10	37P	18.00	22.30	22.90	19.10
16P	7.50	11.80	12.40	8.60	38P	18.50	22.80	23.40	19.60
17P	8.00	12.30	12.90	9.10	39P	19.00	23.30	23.90	20.10
18P	8.50	12.80	13.40	9.60	40P	19.50	23.80	24.40	20.60
19P	9.00	13.30	13.90	10.10	42P	20.50	24.80	25.40	21.60
20P	9.50	13.80	14.40	10.60	45P	22.00	26.30	26.90	23.10
21P	10.00	14.30	14.90	11.10	46P	22.50	26.80	27.40	23.60
22P	10.50	14.80	15.40	11.60	50P	24.50	28.80	29.40	25.60
23P	11.00	15.30	15.90	12.10	54P	26.50	30.80	31.40	27.60
24P	11.50	15.80	16.40	12.60	55P	27.00	31.30	31.90	28.10
25P	12.00	16.30	16.90	13.10	60P	29.50	33.80	34.40	30.60

燦達電子工業股份有限公司
 JOINT TECH ELECTRONIC IND. CO., LTD.

REV.	DESCRIPTION	DATE	NAME
A5	EN20191023040	2019.09.20	吳清
A4	EN1812030003	2018.12.03	徐富永
A3	EN1611160002	2016.11.30	徐富永
A2	EN1308210292	2013.08.21	唐騰鳳
A1	EN1304260133	2013.04.26	權生新
A0	NEW RELEASE	2010.08.19	權生新

UNIT	SCALE	SHEET
mm	1 : 1	1 of 2
DRAWN BY		APPROVED BY
權生新		董正一
2010.08.19		2010.08.19
GENERAL TOLERANCE		
X. X±0.25	ANGLE±	
X. XX±0.15		
X. XXX±0.05		

TITLE:
 0.50mm PITCH FFC/FPC
 CONNECTOR, 90° SMT TYPE,
 ZIF, BOTTOM CONTACT STYLE

DRAW NO.: F0515WR-S-XPXXXXXXX REV. A5



04~23 Contacts

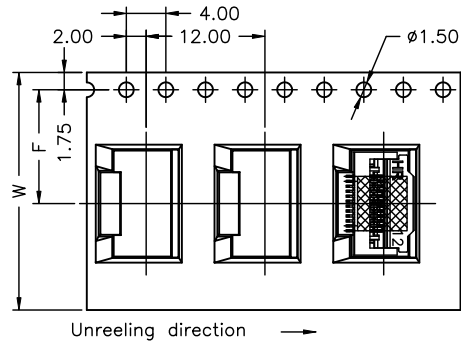

24~60 Contacts

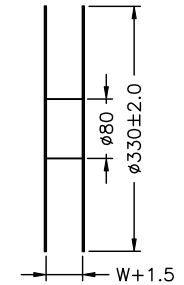
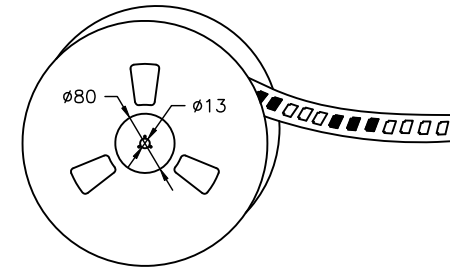
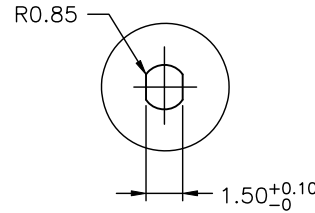
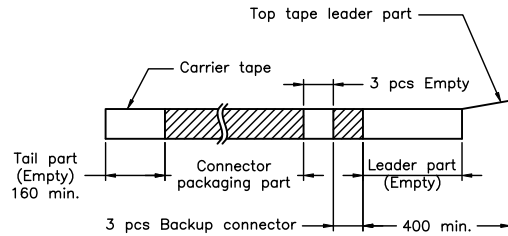
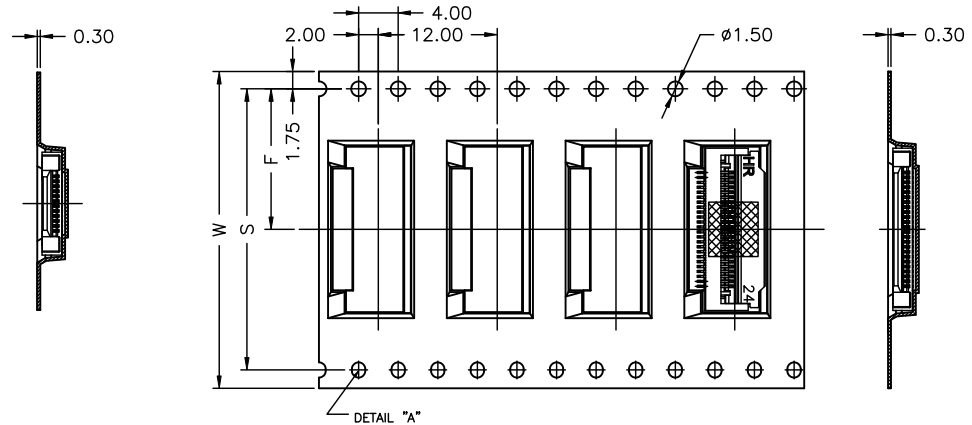

Number of Contacts	W±0.3	F±0.1	S±0.1	Q'ty/Reel	Number of Contacts	W±0.3	F±0.1	S±0.1	Q'ty/Reel
04P	16	7.50	28.40	2,000	26P	32	14.20	28.40	2,000
05P	16	7.50		2,000	27P	32	14.20	28.40	2,000
06P	16	7.50		2,000	28P	32	14.20	28.40	2,000
07P	16	7.50		2,000	29P	32	14.20	28.40	2,000
08P	16	7.50		2,000	30P	32	14.20	28.40	2,000
09P	24	11.50		2,000	31P	32	14.20	28.40	2,000
10P	24	11.50		2,000	32P	32	14.20	28.40	2,000
11P	24	11.50		2,000	33P	44	20.20	40.40	2,000
12P	24	11.50		2,000	34P	44	20.20	40.40	2,000
13P	24	11.50		2,000	35P	44	20.20	40.40	2,000
14P	24	11.50		2,000	36P	44	20.20	40.40	2,000
15P	24	11.50		2,000	37P	44	20.20	40.40	2,000
16P	24	11.50		2,000	38P	44	20.20	40.40	2,000
17P	24	11.50		2,000	39P	44	20.20	40.40	2,000
18P	24	11.50		2,000	40P	44	20.20	40.40	2,000
19P	24	11.50		2,000	42P	44	20.20	40.40	2,000
20P	24	11.50		2,000	45P	44	20.20	40.40	2,000
21P	24	11.50		2,000	46P	44	20.20	40.40	2,000
22P	24	11.50		2,000	50P	44	20.20	40.40	2,000
23P	24	11.50		2,000	54P	44	20.20	40.40	2,000
24P	32	14.20		2,000	55P	44	20.20	40.40	2,000
25P	32	14.20		2,000	60P	56	26.20	52.40	2,000

				燦達電子工業股份有限公司 JOINT TECH ELECTRONIC IND. CO., LTD.			
				UNIT	SCALE	SHEET	TITLE: 0.50mm PITCH FFC/FPC CONNECTOR, 90° SMT TYPE, ZIF, BOTTOM CONTACT STYLE, TAPING SPEC.
				mm	1 : 1	2 of 2	
A5	EN20191023040	2019.09.20	吳清	DRAWN BY	APPROVED BY		
A4	EN1812030003	2018.12.03	徐富永	權生新	董正一		
A3	EN1611160002	2016.11.30	徐富永	2010.08.19	2010.08.19		
A2	EN1308210292	2013.08.21	唐騰鳳	GENERAL TOLERANCE			
A1	EN1304260133	2013.04.26	權生新	X. X±0.25	ANGLE±		
A0	NEW RELEASE	2010.08.19	權生新	X. XX±0.15			
REV.	DESCRIPTION	DATE	NAME	X. XXX±0.05			DRAW NO. : F0515WR-S-XPXXXXXXX