

Ordering code

A2545 H-XP XXX

① ② ③ ④

① Series No.
 ② Connector type: H=Housing
 ③ No. of circuits
 ④ Option code:
 Blank=PBT,UL94V-0, Color: Natural(Black)
 -WH=PBT,UL94V-0, Color: Natural(White)

SPECIFICATIONS

Current Rating: 3A AC,DC
 Voltage Rating: 250V AC,DC
 Temperature Range: -25°C ~ +85°C
 Contact Resistance: 20mΩ Max.
 Insulation Resistance: 1000MΩ Min.
 Withstanding Voltage: 1500V AC/minute

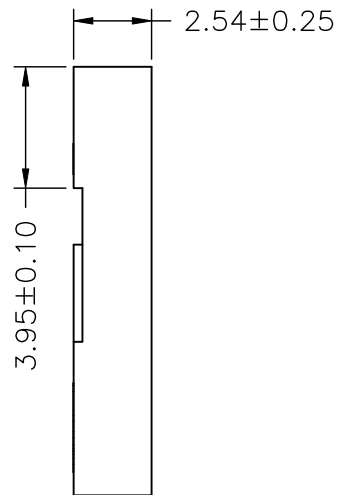
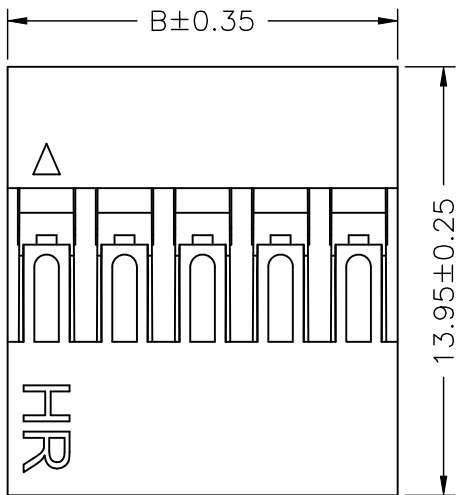

Circuit No.	Dimensions		Circuit No.	Dimensions	
	A	B		A	B
01P	---	2.54	11P	25.40	27.94
02P	2.54	5.08	12P	27.94	30.48
03P	5.08	7.62	13P	30.48	33.02
04P	7.62	10.16	14P	33.02	35.56
05P	10.16	12.70	15P	35.56	38.10
06P	12.70	15.24	16P	38.10	40.64
07P	15.24	17.78	17P	40.64	43.18
08P	17.78	20.32	18P	43.18	45.72
09P	20.32	22.86	19P	45.72	48.26
10P	22.86	25.40	20P	48.26	50.80

				燦達電子工業股份有限公司 JOINT TECH ELECTRONIC IND. CO., LTD.	
UNIT		SCALE	SHEET		TITLE: 2.54mm PITCH SINGLE ROW HOUSING
mm			1 of 1		
DRAWN BY		APPROVED BY			
董正一		董正一			
2001.02.01		2001.02.01			
GENERAL TOLERANCE					
B5		X. XX±0.25		ANGLE±	
B4		X. XX±0.15			
REV.		DATE			
DESCRIPTION		NAME		REV. C1	